

Hanno®-Roller Blind Box Insulation

Product description

The roller blind box insulation is a combination of an absorption layer – Hanno®-Tect open-cell melamine resin foam – combined with a flexible heavy foil.

Product Properties

The foam layer provides outstanding airborne sound absorption and thermal insulation thanks to its low thermal conductivity value of $< 0.035 \text{ W/(m}\cdot\text{K)}$. The soft, flexible heavy film stabilizes the roller blind housing and increases its grammage, thus reducing sound permeability. In addition to the product's excellent characteristics, the sheets are easy to install due to a self-adhesive layer. Minimal heat losses due to cold and sound bridges, improved sound insulation and thermal insulation in the roller shutter box.

Sound absorption according to ISO 10534-2:

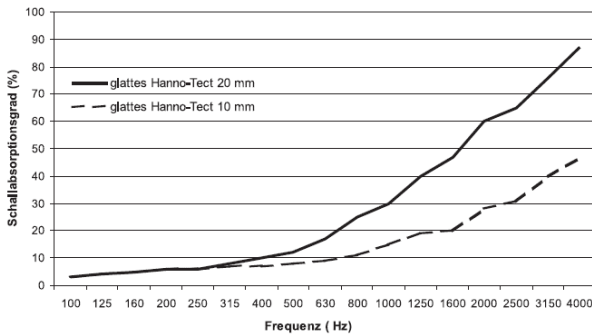

Application

Roller blind box insulation, heat and sound insulation.

Technical Data

Colour	-	Gray (foam), black (Heavy Layer)
Sound absorption (Foam)	ISO 10534-2	40% (250 Hz, 20mm)
Loss factor (Heavy layer)	EN ISO 6721-3	5kg/m ² : 0,120 (20°C, on 1mm Steel plate, 200Hz)
Thermal conductivity faoam	DIN EN 12667	0,035 W/mK (10°C, d = 50mm)
Temperature stability	-	-30°C - 80°C (applied)
Shelf life	-	6 month **

**Storage environment: 5-25°C, dry, protected from ultraviolet radiation and weather, in original packaging (or equivalent).

Hanno Werk GmbH & Co. KG

Hanno-Ring 3-5
D-30880 Laatzen
Germany
Telefon: +49 5102 7000-0
info@hanno.com
www.hanno.com

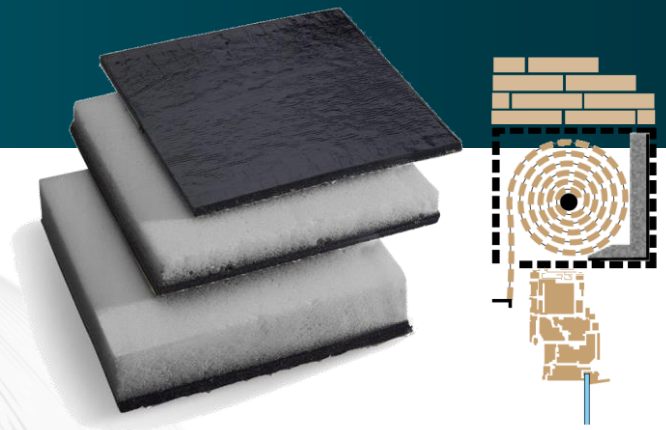

Form of Delivery

Sheets, cut according to quantity up to a maximum of 2m x 1m. Standard types and formats available:

Panel Dimension [mm]	Panel structure
1000 x 250 x 3	Heavy Foil / Self adhesive
1000 x 250 x 10	Heavy Foil /Hanno®-Tect
1000 x 250 x 20	Heavy Foil / Hanno®-Tect

Processing

Clean the substrate from dust, grease, oil, and water. Ensure a rich, full-surface bonding. The adhesion strength of cold bonding depends decisively on the contact pressure. Therefore, the parts must be carefully pressed firmly over the entire surface. An application roller is suitable for this purpose. Cold bonding should not be carried out below 15°C material temperature. On absorbent substrates, Hanno®-MS film adhesive, Hanno® mounting adhesive, or Hanno® sealing adhesive F can be used as an additional mounting aid.

If necessary, a pre-coating with diluted adhesive is recommended. On suitable substrates, the material can be nailed. On very smooth substrates, it may be necessary to additionally bond with double-sided adhesive tape.



Hanno[®]-Roller Blind Box

Cleaning

No significant soiling by the material is to be expected. When using self-adhesive components, residue adhesive can be removed with a petroleum-based cleaning agent, if necessary. Please observe the safety regulations for the used cleaning agent.

Environment and disposal

The Material can be disposed of as residential waste according to local disposal regulations.

Safety Instructions

Based on available data and experience, the product is not a hazardous substance as defined by the Hazardous Substances Regulation and corresponding EU directives. We recommend however that you take the same care and use the same hygiene as is customary with working materials.

Restriction of liability

Our General Terms and Conditions of Sales with the warranty conditions which you can refer to at **www.hanno.com**, apply. This data sheet provides non-binding information without the assurance of guarantee. The stipulated instructions for use are to be adapted to the given conditions. The user is obligated to validating the suitability and application possibility of the product by testing it himself, so as to avoid failures for which we assume no liability. The right to make technical changes is reserved.

You can request the latest version of this datasheet from **info@hanno.com**.

Hanno Werk GmbH & Co. KG

Hanno-Ring 3-5
D-30880 Laatzen
Germany
Telefon: +49 5102 7000-0
info@hanno.com
www.hanno.com

