

# Hanno®-In-Front-of-Wall Installation System

## Product description

The Hanno®-In-front-of-Wall Installation System consists of a thermally insulating load-bearing mounting console made of recycled polyurethane foam in various design variants, the highly adhesive Cosmo HD 100.220 (Hanno® MS adhesive), and the Hannoband®-3E BG1, as well as other sealing materials such as Hannoband®-BG1 and Hanno® flashing tape DUO Easy. The Hanno®-In-Front-of-Wall Installation System is used for load transfer and fixing of windows and doors in the pre-wall area with a surrounding frame system. The pre-wall mounting frame is bonded all around with an adhesive tested for the system and additionally mechanically secured according to the manufacturer's instructions. Windows and doors can be installed in the Hanno®-In-Front-of-Wall Installation System according to recognized rules of technology/RAL installation guidelines.

## Product properties

- Component testing according to ift guideline MO-01/1
- Air tightness  $< 0.1 \text{ m}^3/(\text{h}\cdot\text{m}\cdot(\text{daPa})^{2/3})$  (EN 12114)
- Driving rain tightness  $\geq 600 \text{ Pa}$  (EN 1027)
- Profiles pre-drilled at 6 cm edge spacing for time-saving installation
- Factory-bonded insulation strips on the Hanno® pre-wall mounting frame
- Primer-free bonding (sufficiently stable substrate must be ensured)
- Optimization of secondary sound paths
- Burglary resistance of the tested system up to class RC 2 according to EN 1627-1630 test report 45-22/16
- Improvement of the length-related heat transfer coefficient through optimized installation position as described in the HANNO passive house study
- "Certified Passive House Component pHB" for the installation of window elements in the wall of passive houses
- Low thermal conductivity
- Tested water vapor diffusion resistance and moisture absorption
- Class E according EN 13501-1
- CFC, HCFC, and formaldehyde-free

## Hanno® In-Front-of-Wall Installation Element

Thermally optimized with XPS insulation, which is firmly connected to the mounting profile - no additional bonding necessary. Projection: 84 mm. Pre-drilled for time-saving installation.

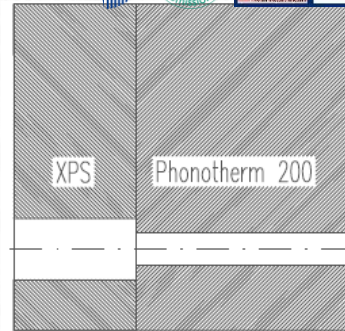

## Hanno® In-Front-of-Wall Installation Angled Element

For a projection of 120 mm to 200 mm, bonded and screwed with interlocking teeth. Pre-drilled for time-saving installation.

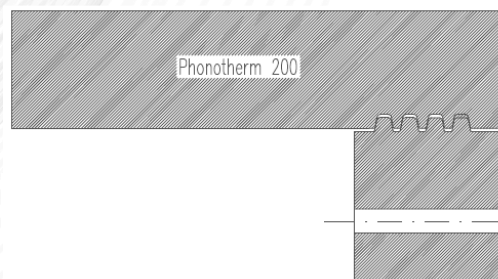

## Form of Delivery

Profiles in 2380 mm and 1190 mm lengths.

## System accessories:

Hanno® MS adhesive (Cosmo HD-100.220) for mounting the Hanno® pre-wall mounting system

Hanno Werk GmbH & Co. KG

Hanno-Ring 3-5  
30880 Laatzen  
Germany

Telefon: +49 5102 7000-0  
info@hanno.com  
www.hanno.com



# Hanno®-In-Front-of-Wall Installation System

Hannoband®-3E BG1 as ift and MPA-tested sealing tape  
 Hannoband®-BG1 as MPA-tested joint sealing tape for connecting the window or facade to the Hanno® pre-wall mounting system

Hanno®-DUO Easy flashing tape, tested and approved by MPA, for connecting the window to the Hanno®-In-Front-of-Wall Installation System.

As additional accessories, you can also obtain spacer mounting screws#.

## Technische Daten

Material		Recycled PUR rigid foam (Phonotherm®) XPS
Density		550 kg/m <sup>3</sup> ±10%
Fire behavior	EN 13501-1 / DIN 4102-1	E / B2
Air tightness system	MO-01/1 / EN 12114	a<<0,1 m <sup>3</sup> /(h m (daPa) <sup>2/3</sup> ), ift*
Water resistance system	MO-01/1 / EN 1027	> 600 Pa, ift*
Load-bearing capacity	static proof	>200 kg/m **
Compression strength	EN 826	>5 MPa (10%)
Flexural strength	EN 310	ca. 7,8 N/mm <sup>2</sup> (15mm in reference)
Screw extraction resistance	EN 320	> 600 N (SPAX®-T-Star plus 4,0x60, in reference)
Maximum rated sound insulation value		Rs,w = 60db
Water vapor diffusion coefficient	EN ISO 12572	μ = ca. 25
Thermal conductivity	EN ISO 12667	0,076 W/(mK) (Phonotherm®) / 0,035 W/(mK) (XPS-strips)
Water absorption		ca. 5% (24h)
Swelling behavior		ca. 1% (24h)
Processing temperature		+10 °C - +30°C
Temperature resistance		-40 - + 100°C
Shelf life		24 months

\* ift: ift Rosenheim; GEV: Gemeinschaft Emissionskontrollierte Verlegewerkstoffe, Klebstoffe und Bauprodukte e.V. \*\* maximum values on request

# The suitability of the fastening screws must be ensured according to the current " Guideline for installation of windows and external pedestrian doors " and, if necessary, protected against corrosion.

Hanno Werk GmbH & Co. KG

Hanno-Ring 3-5  
 30880 Laatzen  
 Germany

Telefon: +49 5102 7000-0  
 info@hanno.com  
 www.hanno.com





# Hanno<sup>®</sup>-In-Front-of-Wall Installation System

### Processing

Please refer to the installation instructions and consult our application engineering.

### Cleaning

Clean skin with water and soap. Removal of impregnation and/or adhesive residues is possible with a solvent-based cleaner. Please observe safety regulations.

### Disposal

Waste material can be disposed of with household waste. Local regulations must be observed.

### Safety Instructions

On the basis of existing data and experience, the product is not hazardous material as defined in the hazardous materi-

als regulations and the corresponding EC directives. However, we recommend that you take the same care and use the same hygiene as with chemical materials.

### Restriction of liability

Our General Terms and Conditions of Sales with the warranty conditions which you can refer to at **www.hanno.com**, apply. This data sheet provides non-binding information without the assurance of guarantee. The stipulated instructions for use are to be adapted to the given conditions. The user is obligated to validating the suitability and application possibility of the product by testing it himself, so as to avoid failures for which we assume no liability. The right to make technical changes is reserved.

You can request the latest version of this datasheet from **info@hanno.com**.

Hanno Werk GmbH & Co. KG

Hanno-Ring 3-5  
30880 Laatzen  
Germany

Telefon: +49 5102 7000-0  
info@hanno.com  
www.hanno.com

